



## Closed loop linear actuator

Part number: **PLB-100A**

Miniature, low force, very fast, single axis intelligent actuator.

It has no limit switches but the enclosed absolute encoder and electronics will not allow you to overdrive the system under normal operation conditions.

Applications include: Very fast, high speed beam steering, scanning, tracking.

Unit price: \$195 (without the optics holder)



Photo

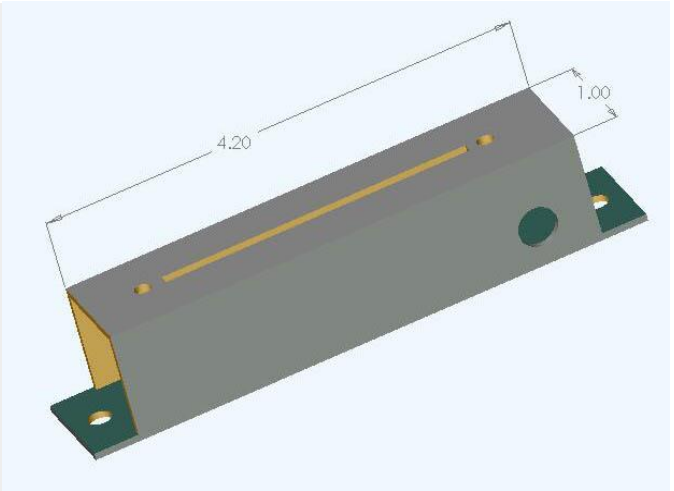

3-D

- Voltage requirements: 10VDC to 12VDC
- Maximum travel 100mm
- Max. pushing force: 0.05N
- Interface for translation platform
- Max. velocity: 500mm/s (20grams load)
- Built-in resistive absolute encoder.
- Resolution: Not specified
- Minimum increment: ~ 1.5mm
- Straightness and flatness: Not specified.
- Linearity: Not specified.
- Size: 1" x 1" x 5" (see 3-D photo)
- Total weigh 0.5 lb
- Optics holder not included.
- Recommended controller **UDA-210**

You can use your own driver which can be a simple adjustable power supply from 0 to 5V DC.